

## **Where do I go for...?**

### **Transcripts and Registration Forms**

#### Registrar's Office

Room 2122, Worrell Professional Building

336.758.5443

### **Pay Tuition**

#### Student Financial Services

Room 107, Reynolda Hall

336.758.5234

*or*

#### Janet Cromer- Associate Director for Admissions and Financial Aid

Suite 2312, Worrell Professional Building

336.758.4603

### **Visa Issues**

Vinithra Sharma- Assistant Director for International Students and Scholars

#### Center for Global Programs and Studies

Room 116, Reynolda Hall

336.758.4978

### **Minor Illness or Injury**

#### Student Health Services Office

George C. Mackie Health Center

Lower Level of Reynolds Gymnasium

336.758.5218

### **Missing/Not Working Deacon OneCard**

#### Deacon OneCard Office

Room 131, Alumni Hall

336.758.1949

### **Email/Computing Problems**

#### Law Information Technology

2nd Floor Offices, Law Library

Worrell Professional Center

336.758.4300







## INTRODUCTION TO THE U.S. LEGAL SYSTEM: LIBRARY RESOURCES

Kenney Hegland, *Introduction to the Study and Practice of Law in a Nutshell* (1983) (Call No. KF273 .H4 1983 – Study Aids – Academic Success Collection 2<sup>nd</sup> Floor).

Jasper Kim, *American Law 101: An Easy Primer on the U.S. Legal System* (2015) (Call No. KF385 .K56 2015 – Ground Floor).

Tracey George and Suzanna Sherry, *What Every Law Student Really Needs to Know: An Introduction to the Study of Law* (2009) (Call No. KF283 .G46 2009 – Ground Floor).

## THE AMERICAN COURTS



The Federal Court System in the United States: An Introduction for Judges and Judicial Administrators in Other Countries, 3d ed. (2010). Office of Judges Programs, Admin. Office of the U.S. Courts (<http://www.uscourts.gov/uscourts/FederalCourts/Publications/English.pdf>).



Understanding Federal and State Courts

([http://www.uscourts.gov/outreach/resources/fedstate\\_lessonplan.htm](http://www.uscourts.gov/outreach/resources/fedstate_lessonplan.htm)) examines the “differences, similarities, and interactions between the federal and state court systems.”

## LEGAL ENCYCLOPEDIAS & DICTIONARIES

The entries in *Gale Encyclopedia of American Law* (formerly *West’s Encyclopedia of American Law*) (Ref. KF154 .G77 2011) define terms and highlight significant concepts, events, cases, and people.

*Black’s Law Dictionary*, 10th ed. (Reference KF156 .B53 2014) is considered the most authoritative American legal dictionary. *A Dictionary of Modern Legal Usage*, 2d ed. (Reference KF156 .G367 1995) and *Mellinkoff’s Dictionary of American Legal Usage* (Reference KF156 .M45 1992) are dictionaries of legal language as used in the U.S. today. *Legal Terminology* (Ref. KF240.B767 2006) provides basic explanations of legal terms.

## LEGAL LANGUAGE/LEGAL WRITING

Rossini, Christine. *English as a Legal Language*, 2d ed. (Reference K50 .R67 1998).

Teply, Larry L. *Legal Writing Citation in a Nutshell* (Reserves KF245 .T47 2008).

## PARTICULARLY FOR INTERNATIONAL STUDENTS...



Brostoff, Teresa Kissane & Ann Sinsheimer. Legal English: An Introduction to the Legal Language and Culture of the United States, 2d ed. (KF272 .B76 2003 – Ground Floor).

Edwards, George E. LL.M. Roadmap: An International Student' s Guide to U.S. Law School Programs (KF272 .E385 2011 – Ground Floor).

Fandl, Kevin J. Lost in Translation: Effective Legal Writing for the International Legal Community (K94 .F36 2013 – Ground Floor).

Gader-Shafran, Rachel. The International Student's Survival Guide to Law School in the United States: Everything You Need to Succeed (KF283 .G33 2003 – Ground Floor).

Wojcik, Mark E. Introduction to Legal English: An Introduction to Legal Terminology, Reasoning, and Writing in Plain English, 2d ed. (KF250 .W65 2001 – Ground Floor).



## **HELPFUL WEBSITES & INFORMATION**

### ***Getting Settled:***

- Getting settled in/nearby grocery stores: <http://cis.wfu.edu/iss/info/settle/>
- International Students and Scholars: <http://global.wfu.edu/iss/>

### ***Classes:***

- Law course descriptions - <http://academics.law.wfu.edu/courses/>
- Law Registrar - <http://registrar.law.wfu.edu/>
- Book List – <http://registrar.law.wfu.edu/current/>
- Student Handbook - <http://studentlife.law.wfu.edu/handbook/>
- Wake Information Network: <https://win.wfu.edu/>

### ***Wake Forest Account:***

- Payment Methods - <http://llm.law.wfu.edu/welcome/payment/>
- Student Financial Services- <http://finance.wfu.edu/sfs>

### ***Health Services/ Insurance:***

- Student Health- <http://shs.wfu.edu/>
- Student Health Insurance- <http://sip.studentlife.wfu.edu/>

### ***Transportation:***

- Ride the Wake Shuttle Schedule - <http://facilities.wfu.edu/transport/ride-the-wake/>
- WFU Motor Vehicle Registration Info - <https://wfuparking.t2hosted.com/cmn/index.aspx>
- Parking: <http://facilities.wfu.edu/transport/parking-and-transportation/>

### ***International Student Organizations/Events of Interest:***

- Amnesty International: <http://groups.wfu.edu/amnestyinternational/index.htm>
- Asian Student Interest Association: <https://sites.google.com/site/wfuasia/>
- Black Student Alliance: <http://wfublackstudentalliance.wordpress.com/>
- Chinese Students & Scholars Association: <http://groups.wfu.edu/CSSA/>
- World Cultural Festival: [http://www.wfu.edu/multicultural/world\\_cultural\\_festival.php](http://www.wfu.edu/multicultural/world_cultural_festival.php)

*The Center for Global Programs and Studies will also add you to an international students/scholars e-mail list to let you know about various events throughout the school year.*



## **Wake Forest Law Student Organizations**

Students are encouraged to consider joining Student Organizations in fields they are interested in. Groups meet regularly and hold functions related to their organization. Below you will find a list of Student Organizations and their leaders. You can find out more information on groups and activities here: <http://studentlife.law.wfu.edu/>

### **Organization**

AAJ Trial Team  
American Constitution Society  
Black Law Student Association (BLSA)  
Christian Legal Society  
Criminal Law Roundtable  
Domestic Violence Awareness Coalition (DVAC)  
Environmental Law Society  
Federalist Society  
Hispanic and Latino Law Student Organization  
Honor Council  
Immigration Law Society  
Journal of Business & Intellectual Property Law  
Law Review  
Moot Court  
National Trial Team  
North Carolina Advocates for Justice  
Outlaw  
Phi Alpha Delta  
Pro Bono Project  
Public Interest Law Organization  
Sports and Entertainment Law Society (SELS)  
Student Animal Legal Defense Fund (SALDF)  
Student Bar Association (SBA)  
Student Health Law Association (SHLA)  
Student Trial Bar  
Teen Court  
Veterans Advocacy Legal Organization (VALOR)  
Wake Forest Journal of Law & Policy  
Wake Intellectual Property Student Association  
Women in Law  
Youth Advocacy Group

### **Name**

Joshua Bussen  
Jaime Garcia  
Alan Bowie  
Adam Nyenhuis  
Katie McAbee  
Dana King  
Alison Ringwood  
David Giffin  
Sabrina Huffman  
Anastasia Fanning  
Bradley Setzer  
Tim McLister  
Don Morgan  
Ryan McIntyre  
Jordan Lee  
Daniel Stratton  
Mackenzie Salenger  
Heather Higgins  
Carson Smith  
Nicholas Griffin  
Cheslie Kryst  
Melissa Wilson  
Joseph Greener  
Delia Goubeaux  
Joshua Bussen  
Dawnielle Grace  
Chris Alderman  
Crissy Dixon  
John Sears  
Allie Vandivier  
Ashlee Johnson



# REYNOLDA CAMPUS MAP



- 1 Wait Chapel/Wingate Hall
- 2 Ebird Residence Hall
- 3 Taylor Residence Hall
- Bookstore, Campus Grounds
- 4 Davis Residence Hall
- Subway, University Police
- 24-Hour Office
- 5 Reynolda Hall
- Cafeteria
- Magnolia Room
- 6 Benson University Center
- Pugh Auditorium, Food Court,
- Shorty's, Post Office
- 7 Z. Smith Reynolds Library
- Starbucks
- 7A Wilson Wing
- 8 Olin Physical Laboratory
- 9 Salem Hall
- 10 Winston Hall

- 11 Luter Residence Hall
- 12 Babcock Residence Hall
- 13 Tribble Hall
- 14 Johnson Residence Hall
- 15 Bostwick Residence Hall
- 16 Collins Residence Hall
- 17 Facilities Management
- 17A University Police
- 17B Central Heating Plant
- 18 Carswell Hall
- 19 Manchester Athletic Center
- 19A Pruitt Football Center
- 20 Calloway Center
- 20A Manchester Hall
- 20B Kirby Hall
- 21 Reynolds Gymnasium
- Student Health Service
- 22 Kitchin Residence Hall
- Deacon Shop
- 23 Poteat Residence Hall
- Zick's

- 24 Huffman Residence Hall
- 25 ROTC Building
- 26 Alumni Hall
- 26A University Advancement
- 26B Residence Life & Housing
- Parking & Transportation
- Deacon One Office
- 27 Residential Community
- 28 WFDD Radio Station
- 29 Museum of Anthropology
- 29A Anthropology Lab
- 30 Piccolo Residence Hall
- 31 Palmer Residence Hall
- 32 Worrell Professional Center
- 33 North Campus Apartments
- 34 Student Apartments
- 35 Scales Fine Arts Center
- Mainstage Theatre
- Hanes Art Gallery
- Brendle Recital Hall
- 36 Starling Hall
- 37 Kentner Stadium
- 38 Leighton Tennis Stadium
- 39 Dianne Dailey Golf Learning Center
- 40 Haddock Golf Center

To Reynolda Road, Silas Creek Pkwy.  
and I-40 Business/Bypass

To Graylyn, Reynolda Village, Reynolda Gardens  
and Reynolda House

- 41 Martin Residence Hall
- 42 Spry Soccer Stadium
- 43 Polo Residence Hall
- 44, 45, 46 Chiller Plants
- 47 Greene Hall
- 48 Tennis Courts
- 49 Polo Road Gate
- 50 University Parkway Gatehouse
- 51 Reynolda Road Gatehouse
- 52 Miller Center
- 53 Porter B. Byrum
- Welcome Center
- 54 South Residence Hall
- 56 Dance Studio
- 59 The Barn
- 60 Farrell Hall
- 61 Dogwood Residence Hall
- 62 Magnolia Residence Hall
- 63 North Campus Dining

Visitor Parking



## Area Map

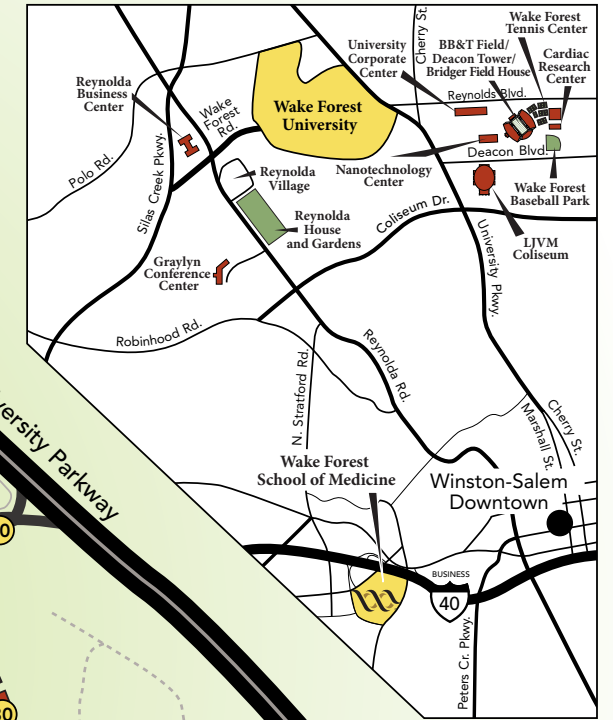

To BB&T Field,  
Bridger Field House,  
Deacon Tower,  
Wake Forest Tennis Center,  
LJVM Coliseum and  
Wake Forest  
Baseball Park



## DIRECTIONS

*Note: Visitors to the Reynolda Campus will find it more convenient to take I-40 Business rather than I-40 Bypass.*

**From I-40 Business:** Take Silas Creek Parkway North for approximately 4 miles. Bear right at the Wake Forest University Exit.

**From I-40 Bypass:** Take Exit 188 (Business I-40) to Silas Creek Parkway North Exit.

**From US 52 Northbound:** Take I-40 Business West to Silas Creek Parkway North.

**From US 52 Southbound:** Take University Parkway Exit (turn right off ramp) to campus.

Many airlines serve the Piedmont Triad International Airport, a 30-minute drive from the Wake Forest Campus.

## CAMPUS DIRECTORY

*Area code is 336. If you are dialing a campus extension (758-) from on-campus, dial only the last four digits.*

**Undergraduate Admissions Office**  
Porter B. Byrum Welcome Center, 758-5201

**Dean of the College**  
Reynolda Hall, 758-5311

**Graduate School of Arts and Sciences**  
Reynolda Hall, 758-5301

**School of Law**  
Worrell Center, 758-5430

**Schools of Business**  
Worrell Center and Kirby Hall  
Graduate Programs, 758-5422  
Undergraduate Programs, 758-5304

**Divinity School**  
Wingate Hall, 758-5121

**School of Medicine**  
Bowman Gray Campus, 716-4264

**Alumni Activities Office**  
758-5264

**Registrar's Office**  
Reynolda Hall, 758-5206

**Athletic Ticket Office**  
Bridger Field House, BB&T Field  
1-888-758-DEAC

**University Police**  
Information, 758-5591  
Emergencies from on-campus extensions, 911  
Emergencies from off-campus numbers, 758-5911

## ACCOMMODATIONS

### Preferred Hotels

Please identify yourself as a Wake Forest guest when making reservations.

*Closest to Campus*

**Graylyn Conference Center**  
1900 Reynolda Road  
(336) 758-2428

**Residence Inn**  
7835 North Point Boulevard  
(800) 331-3131 or (336) 759-0777

*Downtown Winston-Salem*  
**Brookstown Inn**  
200 Brookstown Avenue  
(800) 845-4262 or (336) 725-1120

**Embassy Suites**  
460 North Cherry Street  
(800) 445-8667 or (336) 724-2300

**Hawthorne Inn**  
420 High Street at Business 40  
(877) 777-3099 or (336) 777-3000

**Marriott Hotel**  
425 North Cherry Street  
(877) 888-9762 or (336) 725-3500

**Wingate Inn**  
125 South Main Street  
(800) 228-1000 or (336) 714-2800

### Other Hotels

*Closest to Campus*

**Clarion Sundance Hotel**  
3050 University Parkway  
(336) 723-2911

**Courtyard by Marriott**  
3111 University Parkway  
(800) 321-2211 or (336) 727-1277

**Holiday Inn Express**  
110 Miller Street  
(888) 465-4329 or (336) 721-0220

*U.S. 52 Area*

**Comfort Inn**  
200 Mercantile Drive  
(800) 424-6423 or (336) 714-8888

**Hampton Inn and Suites**  
309 Summit Square Court  
(336) 377-3000

**Holiday Inn Select**  
5790 University Parkway  
(888) 465-4329 or (336) 767-9595

**Quality Inn**  
5719 University Parkway  
(877) 424-6423 or (336) 767-9009

*Hanes Mall Area*

**Comfort Suites**  
I-40 at Hanes Mall Boulevard  
(877) 424-6423 or (336) 774-0805

**Courtyard by Marriott**  
1600 Westbrook Plaza Drive  
(800) 321-2211 or (336) 760-5777

**Days Inn**  
3300 Silas Creek Parkway  
(800) 329-7466 or (336) 760-4770

**Fairfield Inn and Suites**  
1680 Westbrook Plaza Drive  
(800) 228-2800 or (336) 714-3000

**Hampton Inn**  
1990 Hampton Court at I-40  
(800) 445-8667 or (336) 760-1660

**Hilton Garden Inn**  
1325 Creekshire Way  
(336) 765-1298

**Holiday Inn Express**  
2520 Peters Creek Parkway  
(888) 465-4329 or (336) 788-1980

**Quality Inn and Suites**  
2008 South Hawthorne Road  
(877) 424-6423 or (336) 765-6670

**Sleep Inn**  
1985 Hampton Inn Court  
(877) 424-6423 or (336) 774-8020



- 1 Wait Chapel/Wingate Hall
- 2 Eford Residence Hall
- 3 Taylor Residence Hall
- Bookstore, Campus Grounds
- 4 Davis Residence Hall
- Subway, University Police 24-Hour Office
- 5 Reynolda Hall
- Cafeteria
- Magnolia Room
- 6 Benson University Center
- Pugh Auditorium, Food Court, Shorty's, Post Office
- 7 Z. Smith Reynolds Library
- Starbucks
- 7A Wilson Wing
- 8 Olin Physical Laboratory
- 9 Salem Hall
- 10 Winston Hall

- 11 Luter Residence Hall
- 12 Babcock Residence Hall
- 13 Tribble Hall
- 14 Johnson Residence Hall
- 15 Bostwick Residence Hall
- 16 Collins Residence Hall
- 17 Facilities Management
- 17A University Police
- 17B Central Heating Plant
- 18 Carswell Hall
- 19 Manchester Athletic Center
- 19A Pruitt Football Center
- 20 Calloway Center
- 20A Manchester Hall
- 20B Kirby Hall
- 21 Reynolds Gymnasium
- Student Health Service
- 22 Kitchin Residence Hall
- Deacon Shop
- 23 Poteat Residence Hall
- Zick's
- 24 Huffman Residence Hall
- 25 ROTC Building
- 26 Alumni Hall
- 26A University Advancement
- 26B Residence Life & Housing
- Parking & Transportation
- Deacon One Office

- 27 Residential Community
- 28 WFDD Radio Station
- 29 Museum of Anthropology
- 29A Anthropology Lab
- 30 Piccolo Residence Hall
- 31 Palmer Residence Hall
- 32 Worrell Professional Center
- 33 North Campus Apartments
- 34 Student Apartments
- 35 Scales Fine Arts Center
- Mainstage Theatre
- Hanes Art Gallery
- Brendle Recital Hall
- 36 Starling Hall
- 37 Kentner Stadium
- 38 Leighton Tennis Stadium
- 39 Dianne Dailey Golf Learning Center
- 40 Haddock Golf Center

To Reynolda Road, Silas Creek Pkwy. and I-40 Business/Bypass

To Graylyn, Reynolda Village, Reynolda Gardens and Reynolda House

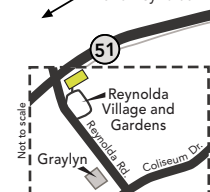

- 41 Martin Residence Hall
- 42 Spry Soccer Stadium
- 43 Polo Residence Hall
- 44, 45, 46 Chiller Plants
- 47 Greene Hall
- 48 Tennis Courts
- 49 Polo Road Gate
- 50 University Parkway Gatehouse
- 51 Reynolda Road Gatehouse
- 52 Miller Center
- 53 Porter B. Byrum
- Welcome Center
- 54 South Residence Hall
- 56 Dance Studio
- 59 The Barn
- 60 Farrell Hall
- 61 Dogwood Residence Hall
- 62 Magnolia Residence Hall
- 63 North Campus Dining

- 64
- 65
- 66
- 67
- 68
- 69
- 70
- 71
- 72
- 73
- 74
- 75
- 76
- 77
- 78
- 79
- 80
- 81
- 82
- 83
- 84
- 85
- 86
- 87
- 88
- 89
- 90
- 91
- 92
- 93
- 94
- 95
- 96
- 97
- 98
- 99
- 100

# PARKING MAP



WAKE FOREST  
UNIVERSITY

## Parking Legend

- General Parking
- Faculty/Staff Parking
- Employee Off-Campus Parking Only
- Satellite/Freshman Lot
- Sophomore Parking
- Reserved Parking
- Off-Campus Parking (OC)
- Visitor/Off Campus Employee Parking
- Visitor Parking
- Winston-Salem First Church Vehicle Parking Only
- WFU-Owned Residential Theme Housing
- Call Boxes (Emergency Phones)

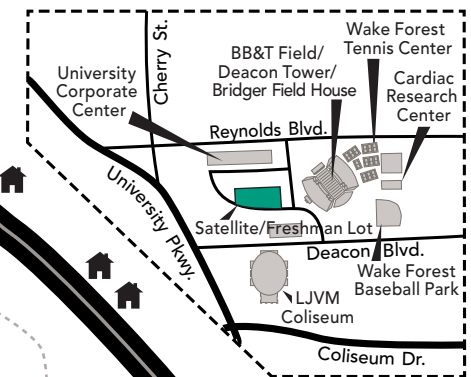
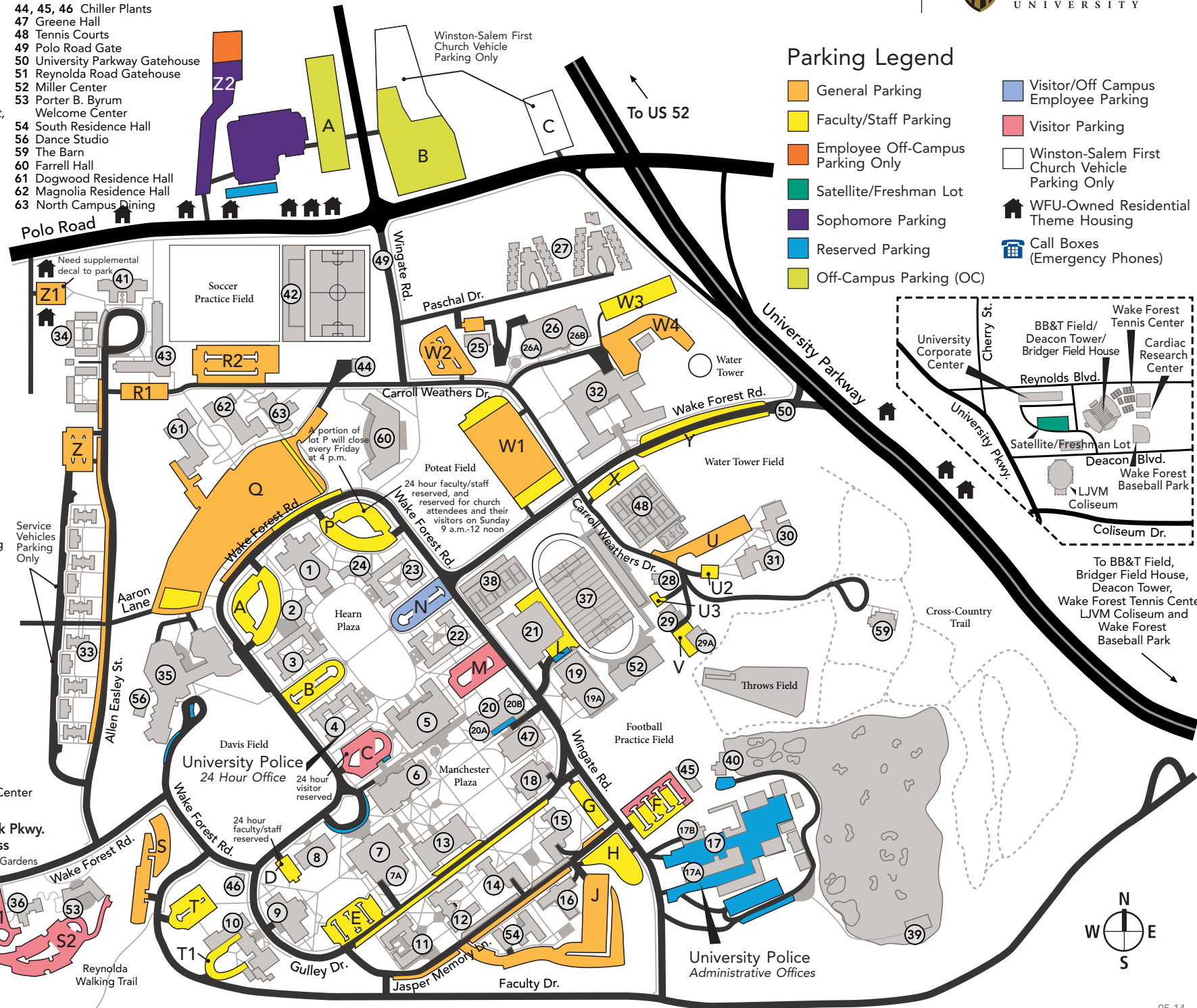







# WAKE FOREST DINING - REYNOLDA CAMPUS

## LOCATIONS

(Visit [www.wakeforest.campusdish.com](http://www.wakeforest.campusdish.com) for updated hours of operation.)

1. REYNOLDA HALL
  - The Fresh Food Company (Residential)
  - The Magnolia Room (Residential)
2. BENSON CENTER
  - Chick-fil-A (Retail)
  - Take Two (Retail - Deli/Grill)
  - Moe's Southwest Grill (Retail)
  - Forest Greens (Retail - Salad)
  - Shorty's (Restaurant)
  - Sundry (Convenience)
3. DAVIS HALL
  - Subway (Retail)
  - P.O.D. Market (Convenience)
4. Z. SMITH REYNOLDS LIBRARY
  - Starbucks (Coffee)
5. POTEAT HALL
  - Zick's (Retail-Pizza)
6. NORTH DINING HALL
  - The Hilltop Market (Residential)
  - Bistro '34 (Restaurant)
  - Starbucks (Coffee)
  - P.O.D. Market (Convenience)
7. FARRELL HALL
  - Einstein Bros Bagels (Retail/Coffee)
8. WORRELL HALL
  - Worrell Convenience Store
9. CAMPUS GROUNDS
  - Campus Coffee

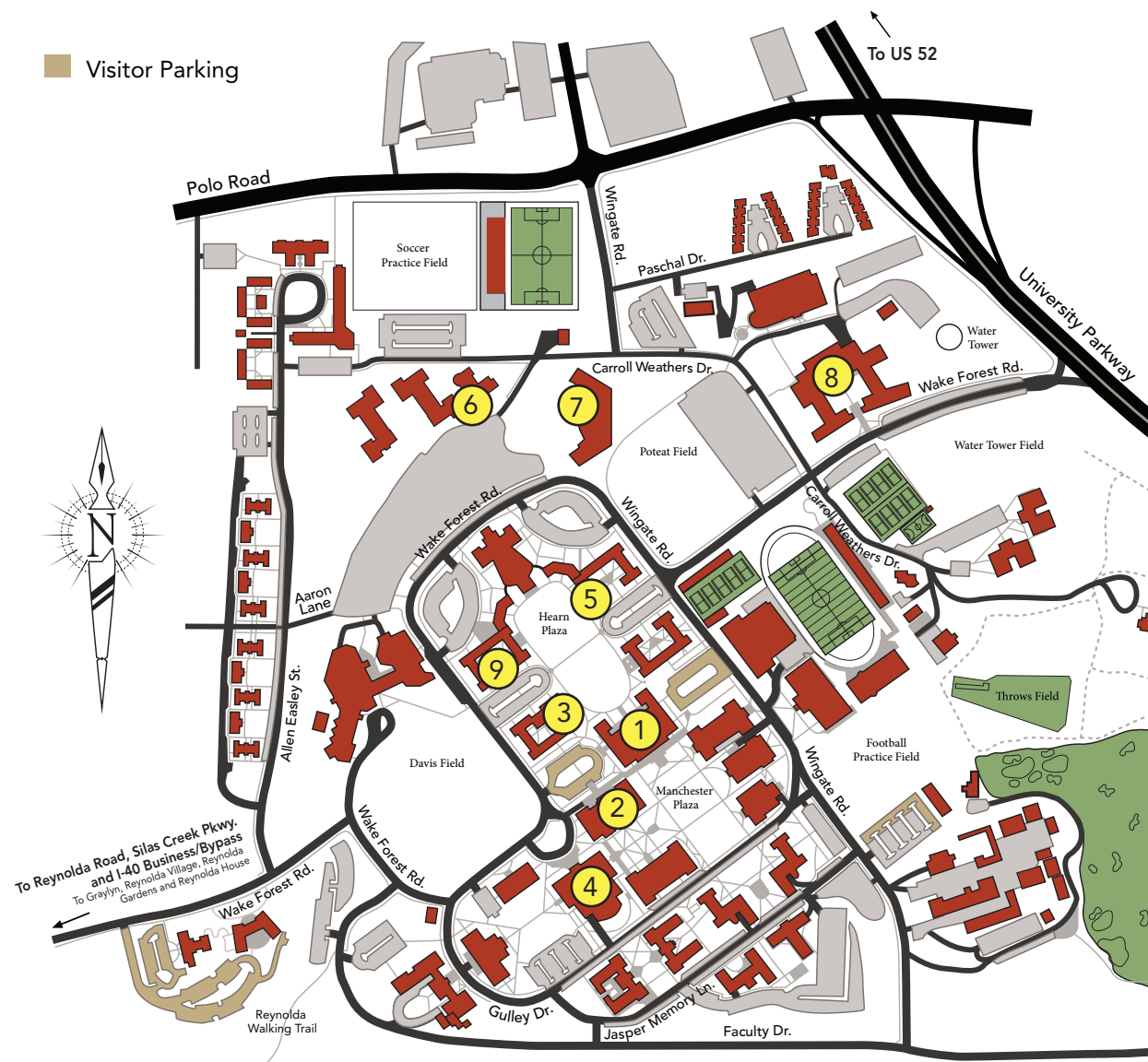

View current hours of operation at [www.wakeforest.campusdish.com](http://www.wakeforest.campusdish.com)









## Graduate Student Meal Plan Options

Too busy studying to leave campus? Want someone else to do the cooking for you? Consider a meal plan for any of the many dining facilities on campus.

You can find more information on the many options for dining here: <http://wakeforest.campusdish.com/>

Below are the options available to you. You can select a plan by logging on to win.wfu.edu and selecting the Dining Services link under the Personal tab. If you have any questions or problems, you can contact Residence Life and Housing at 336.758. 5185 or at <http://rlh.wfu.edu/contact-us/>.

				
Product Name	<u><b>Screamin' Plan</b></u>	<u><b>Apartment Style Plan</b></u>	<u><b>Commuter Plan</b></u>	<u><b>Gold Plan</b></u>
Price	<b>\$1,489.00</b>	<b>\$821.00</b>	<b>\$520.50</b>	<b>\$2,152.00</b>
Description	<p>Average of 6 meals per week. Available to north residents, upperclassmen, and off-campus students.</p> <p>Meal Swipes: 100 Old Gold Swipes: 25 Food Dollars: 400</p>	<p>Average of 3 meals per week. Available to north apartment residents and off-campus students.</p> <p>Meal Swipes: 50 Old Gold Swipes: 13 Food Dollars: 250</p>	<p>Renew each semester! It's a great source of grab and go convenience from venues located all across campus!</p> <p>Meal Swipes: 30 Old Gold Swipes: 8 Food Dollars: 200</p>	<p>Average of 7 to 8 meals per week. Available to north residents, upperclassmen, and off-campus students.</p> <p>Meal Swipes: 125 Old Gold Swipes: 30 Food Dollars: 700</p>



## CAMPUS RECREATION HOURS OF OPERATION

<http://campusrec.studentlife.wfu.edu/>

<b>Reynolds Gymnasium</b>
<b>Monday- Friday</b>
12 p.m.- 11:00 p.m.
<b>Saturday</b>
12 p.m. - 10:00 p.m.
<b>Sunday</b>
1:00 p.m. -11:00 p.m.
<b>Miller Fitness Center</b>
<b>Monday- Thursday</b>
5:30 a.m. - Midnight
<b>Friday</b>
5:30 a.m. – 6 p.m.
<b>Saturday</b>
1:00 p.m. to 7:00 p.m.
<b>Sunday</b>
1:00 p.m. to Midnight
<b>Reynolds Gym Pool</b>
<b>Monday , Tuesday, Thursday</b>
7am – 8:30am; 11am – 1pm; 3pm – 5:30pm; 5:30pm – 8pm – Open Swim
<b>Wednesdays</b>
7am – 8:30am; 11am – 1:30pm; 3pm – 5:30pm; 5:30pm – 8pm – Open Swim
<b>Friday</b>
7am – 8:30am; 11am – 2pm; 3pm – 6pm – Open Swim
<b>Saturday and Sunday</b>
1pm – 4pm
<b>Crux Climbing Wall</b>
<b>Monday- Thursday</b>
2:00 p.m. to 10:00 p.m.
<b>Friday</b>
2:00 p.m. to 6:00 p.m.
<b>Outdoor Pursuits Main office</b>
Monday – Friday (12pm – 6pm)
<b>Water Tower Outdoor Basketball Courts</b>
<b>Everyday</b>
8:00 a.m. to 12:00 p.m.
<b>Upper 8 Tennis Courts</b>
Always Open
<b>Cross Country Trails</b>
Always Open
<b>Sand Volleyball Courts</b>
Always Open
Summer Hours for all facilities can be found at <a href="http://campusrec.studentlife.wfu.edu/hours/">http://campusrec.studentlife.wfu.edu/hours/</a>



## How to Register for an Intramural Sport

<http://campusrec.studentlife.wfu.edu/intramural/how-to-register/>

All students are allowed and encouraged to participate in WFU Intramural Sports. These are teams of students who gather to play various sports on self-chosen teams. There are no try-outs and no restrictions on skill-level, rather the games are for fun and health. You will have the opportunity to compete in various intramural league tournaments

**Step 1: Register with IMLeagues** - All intramural participants will be required to create an account on [IMLeagues.com](http://IMLeagues.com).

- A. Go to [www.imleagues.com](http://www.imleagues.com) and click Create Account.
- B. Enter your information, indicate that you are a WFU student, and submit.
- C. You will be sent an activation email. Click the link in the email to login and activate your IMLeagues account.

**Step 2: After you have created an IMLeagues account:**

- A. Log in to your IMLeagues.com account.
- B. Click the Create/Join Team button at the top right of your User Homepage page (Player Signup)
- C. The current sports will be displayed, click on the sport you wish to join.
- D. Choose the league you wish to play in (Men's, Women's, Co-Rec, etc.)
- E. Choose the division you'd like to play in (Monday 5PM, Tuesday 5PM, etc.)
- F. You can join the sport one of three ways:

### **Create a team (For team captains)**

1. Captains can invite members to their team by clicking the "Invite Members" link on the team page. Any invited members must accept the invitation to be joined to your team.
2. If they've already registered on IMLeagues: search for their name, and invite them.
3. If they haven't yet registered on IMLeagues: scroll down to the "Invite by Email Address" box, and input their email address.

### **Join a team**

1. Use the Create/Join Team Button at top right of every page
2. Accept a request from the captain to join his team.
3. Find the team and captain name on division/league page and requesting to join
4. Go to the captain's playercard page, viewing his team, and requesting to join

### **Join as a Free Agent-**

You can list yourself as a free agent in as many divisions within a league as you'd like. You will be visible to all members of the site and can request to join teams, or post information about yourself so teams can request to add you to their team.

**\*\*You can also email [booktd@wfu.edu](mailto:booktd@wfu.edu) and request to be placed on a team.**



# Wake Forest University

## Walking and Running Trails

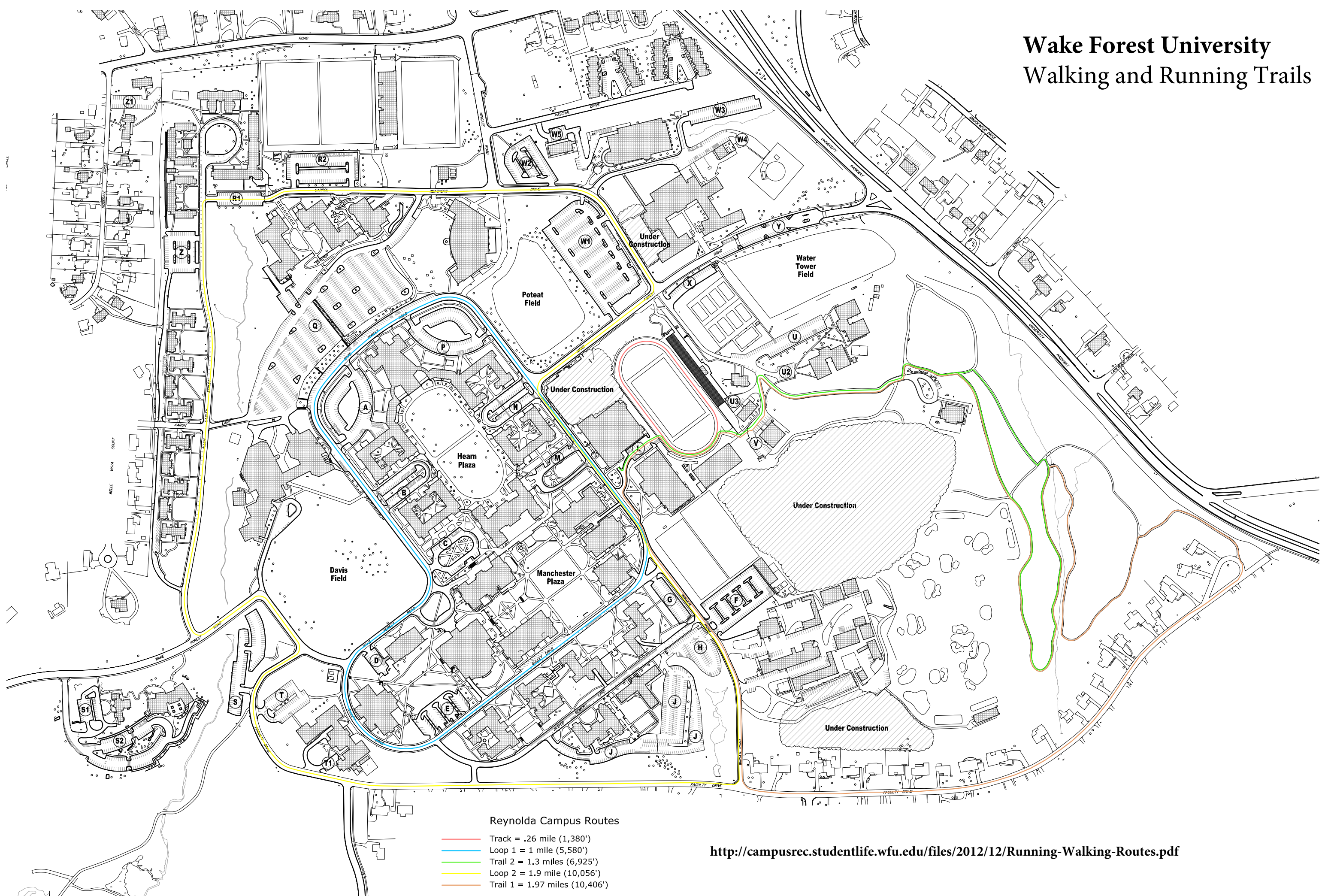







## **RELIGIOUS ACTIVITIES AND GROUPS AT WAKE FOREST**

### **Baptist Student Union**

<http://www.wfubsu.com/>

Rev. Chris Towles, Baptist Campus Minister

Tuesdays, 6pm, BSU Lounge (beneath the Deacon Shop)

### **Emmaus – Multi-denominational**

<http://www.1stpres.com/Emmaus/>

Jessica Steiner, intern

Tuesdays, 7:00pm, Davis Chapel

### **Episcopal Student Fellowship**

<http://campuslifeleadership18642.orgsync.com/org/episcopalstudentfellowship>

Rev. Sarah Carver, Interim Campus Minister

Sundays, Holy Communion, 6pm, Davis Chapel

### **Hillel**

<http://jewishlife.wfu.edu/>

[jewishwf@wfu.edu](mailto:jewishwf@wfu.edu)

Shabbat dinners every other week

Synagogue in Winston Salem

[www.templemanuel.com](http://www.templemanuel.com)

Temple Emanuel

201 Oakwood Dr

Winston Salem, NC 27103

### **Lutheran Student Movement**

Pastor Laura Wind, Campus Pastor

Tuesdays, 6:15pm Catholic Lounge, Basement Level, Collins Residence Hall

### **Muslim Student Association**

[http://events.wfu.edu/group/muslim\\_student\\_association](http://events.wfu.edu/group/muslim_student_association)

Imam Khalid Griggs ([griggaska@wfu.edu](mailto:griggaska@wfu.edu)), Associate Chaplain for Muslim Life

Community Mosque of Winston Salem

[www.communitymosque.com](http://www.communitymosque.com)

1419 Waughtown Street

Winston-Salem, NC 27117

### **Orthodox Christian Fellowship**

Fr. Deacon Constantine Shepherd, Campus Minister

Wednesdays, 7pm, Benson Center



**Presbyterian Student Fellowship**

<http://groups.wfu.edu/PSF/>

Rev. Glenn Otterbacher, Campus Minister

Tuesdays, 6:15pm, Campus Ministry Lounge, Basement of Collins Residence Hall

**RUF (Reformed University Fellowship)**

<http://www.wake.ruf.org/>

Presbyterian Church in America

Rev. John Bourgeois, Campus Minister

Tuesdays, 8pm, Pugh Auditorium

**Wake Forest Catholic Community**

<http://www.wakeforestcatholic.org/>

Fr. Charles Jagodzinski, OFM, Conv., Campus Minister

Wednesdays, 6pm, Community Dinner in the Catholic Community Lounge, Basement of Collins Residence Hall

Masses in Davis Chapel: Monday-Friday, 12:15pm, Sunday 11:30am, 8pm and 10pm

**WFU Wesley Foundation**

<http://www.wakeforestwesley.com/#!>

United Methodist Campus Ministry

Rev. Larry Jones, Campus Minister

Thursdays, 5:30pm, Lower Auditorium, Wingate Hall